

**THE CORPORATION OF THE MUNICIPALITY OF SOUTH DUNDAS**

**BY-LAW NO. 2026-41**

**A By-Law of the Corporation of the Municipality of South Dundas to assess the maintenance costs of Branch 3 and Branch 3 Spur of the Marcellus Municipal Drain.**

**WHEREAS** section 74 of the *Drainage Act*, R.S.O. 1990, c. D.17 (the "Act") authorizes a municipality to maintain and repair a drain constructed under the Act and to assess the costs thereof upon the lands and roads in the drainage area in the same proportion as the original construction assessment;

**AND WHEREAS** the maintenance works requested on Branch 3 & Branch 3 Spur of the Marcellus Drain are now complete and the accumulated costs are \$4,571.05;

**AND WHEREAS** the applicable 1/3 grant has been deducted from the gross assessment for agricultural lands;

**AND WHEREAS** it is necessary to levy the respective costs in the same proportion as authorized in construction By-Law No. 21-1982 of the former Township of Williamsburg.

**NOW THEREFORE** the Council of the Corporation of the Municipality of South Dundas enacts as follows:

1. The assessments as detailed in Schedule "A" are hereby levied on the applicable properties and are due and payable on or before June 30, 2026.
2. Late payments will accrue interest at the prevailing tax rate of 1.25% per month.

**READ** and passed in open Council, signed and sealed this 13<sup>th</sup> day of May, 2026.

  
MAYOR

  
CLERK

**SCHEDULE A**  
To By-Law No. 2026-41

Marcellus Drain (21-1982)

Roll # (0506-)	Assessed Amount	
	Branch 3	Branch 3 Spur
001 006 73400	\$ 6.33	\$ 5.04
001 006 73000	3.49	2.78
001 006 72902	4.56	3.88
001 006 72910	2.73	2.33
001 006 72900	14.58	12.40
001 006 72800	20.29	17.03
001 006 74690	12.22	13.77
001 006 74600	54.48	61.38
001 006 75200	63.58	456.60
001 006 75300	3.12	4.07
001 006 75800	842.49	305.67
001 006 74900	19.66	
001 006 78300	901.78	
001 006 78250	5.00	
001 006 78800	180.27	
Municipality of South Dundas	34.96	59.90
	<u>\$ 2,169.54</u>	<u>\$ 944.86</u>

LEGEND FOR PROFILE		LEGEND FOR PLAN	
HUBLINE (AVG. GND. ELEV.)		MAIN DRAIN	
EXISTING DITCH BOTTOM		DRAINAGE AREA	
PROPOSED NEW BOTTOM		FLOW DIRECTION	
EARTH EXCAVATION		UTILITY CABLES	
HARDPAN EXCAVATION			
ROCK EXCAVATION			
REVISION N°	DATE	REMARKS	

PLAN AND PROFILE OF THE  
**MARCELLUS DRAIN**  
AND BRANCHES

TOWNSHIP OF WILLIAMSBURG

CONSTRUCTION  
MAINTENANCE AND IMPROVEMENTS 1982

SCALE	DATE	DWG. N°	FILE N°
1:12000	MARCH 12, '82	1 of 5	WMSB-87

STIDWILL AND ASSOCIATES LIMITED  
CONSULTING CIVIL ENGINEERS  
CORNWALL ONTARIO  
PER *J.D. Stidwill*  
P. ENG

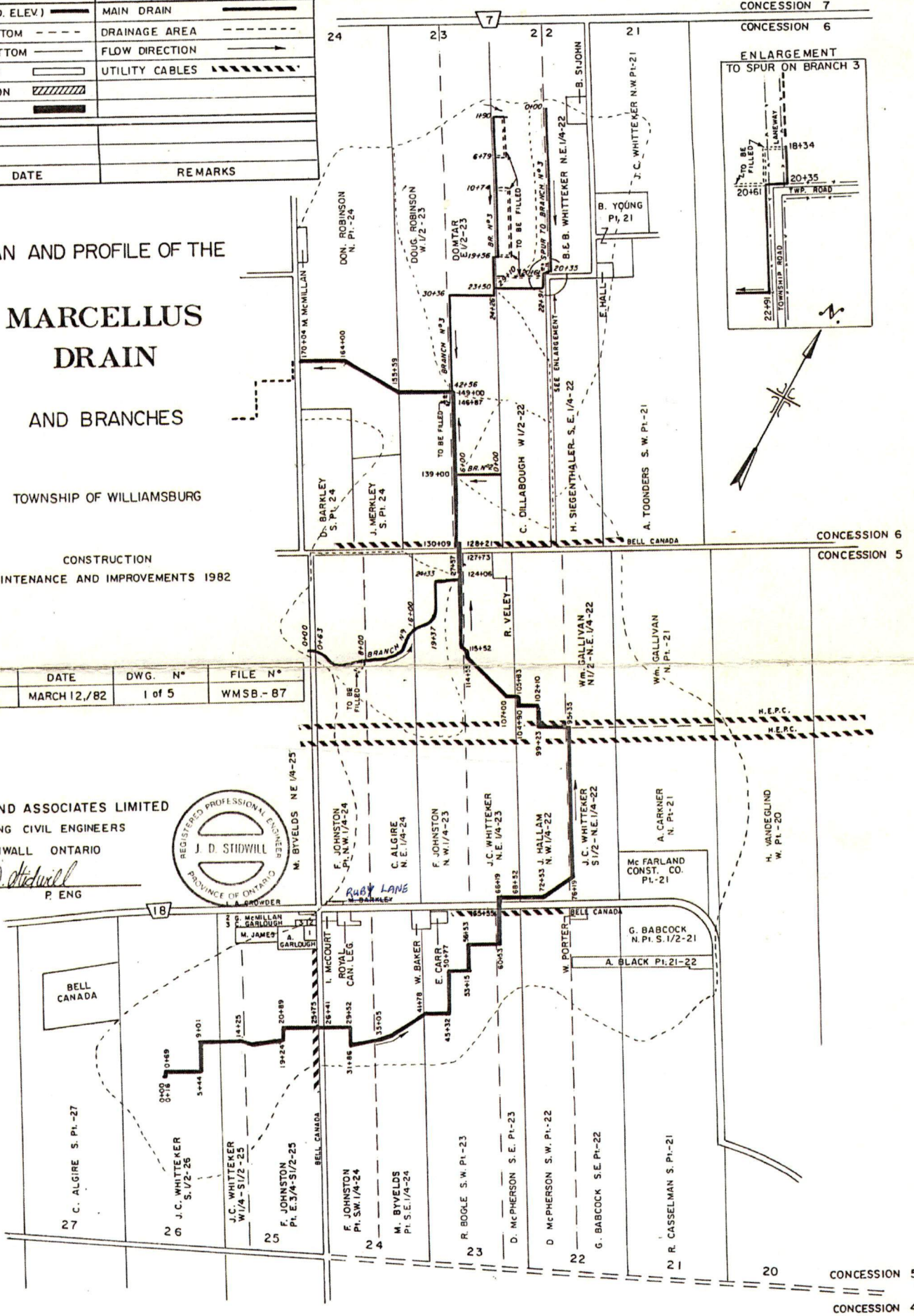

CONCESSION 5  
CONCESSION 4