

STIDWILL & ASSOCIATES LIMITED
CONSULTING ENGINEERS
CORNWALL, ONTARIO

GEORGE COOPER, REEVE
LORNE STRADER, DEP. REEVE
WILLIAM HORNER, CLERK
LORNE MELLON, COUNCILLOR
MICHAEL AULT, COUNCILLOR
ROBERT BENNETT, COUNCILLOR

COUNCIL

ENGINEER'S REPORT
ON THE
BRINSTON MUNICIPAL DRAIN
FOR THE
CORPORATION OF THE TOWNSHIP OF MATILDA
1977

of approximately 100 acres, more or less.

The total length of the Drain is 8835 feet, affecting an area of approximately 100 acres, more or less. Road # 2 to its outlet in the South Branch of the Nation River. north and then turns back to follow the East limit of County Concession Road between Concessions 5 and 6, it continues Village-building lots facing the County Road. Crossing the side of County Road # 2, thence around the East limit of the Drain runs in a general northerly direction along the East of the approximate centre of the Village of Brinston. The Station 4+50, which is a distance of 2170 feet to the South The point of commencement of the Drain will be at

cular drainage basin.

forming a majority of benefitting landowners in this part- is instigated upon a petition by some nine ratepayers, outlet for underground farm tile drainage systems. The work the Village of Brinston, and at the same time creating an drain, for the purpose of relieving flood conditions around The proposed work consists of the construction of a

Section 4 of the Drainage Act - 1975.

The following report is respectfully submitted under

Gentlemen:

Township of Matilda

To the Reeve and Members of Council

1977

TOWNSHIP OF MATILDA

BRINSTON MUNICIPAL DRAIN

ENGINEER'S REPORT

PRESENT CONDITION

The present ditch is very shallow and can not provide adequate drainage for the adjoining farmlands and village-lots. Frequent flooding results with lands staying wet for a great part of the growing season.

WORK RECOMMENDED

It is recommended that a Drain be constructed to the dimensions shown on the accompanying profile which forms a part of this report. Widening will be done to the side adjacent to the village lots, so as to prevent destroying of survey bars and reference points indicating the corners of the properties. Under the scheme adjoining landowners have been given compensation for the value of land taken by the construction of the Drain.

Wherever the Drain does run along County Road # 2, widening will be done to the east side, with the outcoming ground to be used to re-inforce and build up the low easterly shoulder of the road, to the satisfaction of the County Road Department. All the excess spoil shall be spread over the adjoining lands. Generally speaking, the new Drain will run

along the east side of the row of powerpoles along County Road # 2. All road fencing will have to be taken up and re-installed a distance of two feet from the East bank of the

new Drain.

This work will be performed by the contractor and part of his contract. Contractor is not obliged to supply any new fencing material which may be required, as this is included in the Allowance for Damages given to the adjoining landowners.

TOWNSHIP ROAD BRIDGE

The present Township Road culvert in the Concession Road between Concessions 5 and 6 is approximately 2½ feet above grade. The lowering of this culvert is contractor's responsibility as part of his contract. By its appearance it would seem that this culvert can again be used. If, during the process of excavating this road culvert it becomes clear that the pipe should be replaced by a new one, then the Township shall supply the new pipe at their own expense. The installation is contractor's responsibility. Pitrun gravel will be supplied by the Township Road Department. Rip-rap is considered to be unnecessary on this road culvert and is, therefore, not included in the contract. Blacktop will be replaced by the Township Road Department. The amount of deepening of this road culvert is being governed by a recent tile drainage survey plan from the Department of Agriculture in Kempville, affecting W ½ of Lot 18, Concession 5.

FARM ACCESS CULVERT

Under the proposed scheme the replacement of three entrance culverts will be necessary. Contractor will install these crossings as part of his contract, complete with rip-rap and backfill. Supply of the steel culverts will be through the Township Office, and charged against the Drain as part of the cost. After installation each owner shall be responsible for the Maintenance of his own bridge.

ALLOWANCES FOR DAMAGES.

The usual allowances for crop damages have been granted to the owners along the Drain, but this applies only where farmland is concerned. No allowances for crop damages have been made towards village lots, as generally speaking most of the spoil will be spread over the adjoining farmland.

ALLOWANCE FOR LAND TAKEN

The present Drain will be widened mainly towards the East, and an appropriate amount of money should be paid to the owners as compensation for the value of the strip of land taken by the New Drain. The amounts are shown in the Schedule attached to this report

BELL CANADA TOLL CABLE

At Station 61+07 the Drain crosses a Bell Canada underground Toll cable. Contractor shall exercise utmost care in excavating across this cable. Hand-digging is required. Damages to this cable is contractor's responsibility if caused by negligence on his part.

EXTRA DEPTH OF DRAIN REQUIRED FOR DEVELOPMENT ROAD, PROJECT # 1260

Following instructions by Council, dated March 18, 1977, we have re-designed the new ditch bottom by increasing its depth to accommodate development Road, Project # 1260, now in the planning stage. The extra cost has been assessed against the Township of Matilda as part of the cost of Project # 1260.

Under the Drainage Act 1975, this extra cost is not

eligible for the usual grants. For this reason we have

shown this cost separate from the other assessments on the

Drain. Total extra is estimated at \$9,472.94.

FUTURE MAINTENANCE

The Drain shall be maintained by the Township of Matilda

and the cost of this work shall be charged against all the

landowners involved in this scheme and in the same relative

proportion as shown in the attached schedule of Assessment.

ESTIMATE OF COST

Earth Excavation and Spreading	18,035 cu. yds. @ \$1.10 per cu. yd.	\$19,838.50
Lowering Township Road culvert excluding Blacktop and Rip-rap		800.00
Supply and Installation of farm access culverts		4,400.00
Allowances for Land Taken		1,247.91
Allowances for Damages		2,673.51
Engineering Fees, Report, Plans, Specifications		2,800.00
Supervision and Inspection		650.00
Contingencies and Interest		<u>1,500.00</u>
Total Estimated Cost		\$33,909.92

This total Estimated Cost of \$33,909.92 has been apportioned in the following manner:

Outlet Liability Real Property	8,562.56
Outlet Liability Township Roads	1,279.22
Outlet Liability United Counties, County Rd. # 2	1,613.73
Benefit Liability - Real Property	12,981.47
Special Benefit Assessment	9,472.94
Rural Development Road, Project # 1260	<u>9,472.94</u>
Total	\$33,909.92

Included in our Estimated Cost of \$33,909.92 is a special Assessment - Project # 1260, \$9,472.94, made up as follows:

Earth Excavation, 6,035 cu. yds. @ \$1.10 per cu. yd.	\$6,638.50
More Allowance for Land Taken due to increased width of Drain	136.81
Increased Allowance for Damage caused by the Spreading of sterile soil over the adjoining farmland	2,247.63
Engineering, Re-design of Drain, Calculations, etc.	450.00
Total Estimated Cost	\$9,472.94

The Assessment against the Township to this amount is shown under the heading "Project # 1260".

Trusting that this report will meet with your approval, Gentlemen,

We have the honour to be
Your obedient servant

STIDWILL & ASSOCIATES LIMITED

Per F. P. Stidwill

Cornwall, Ontario, July 26, 1977

SCHEDULE OF ASSESSMENT

Name of Owner	Con.	Lot or Part	Acres Drained	Outlet Liability	Benefit Liability
G. Westervelt	5	W.Pt. 16	4	200.26	
Lorne Strader	5	N.Pt. 17	27	1555.70	
Th. Burns	5	N.Pt. 17 (Lot)	3.6	533.58	
H. Allison	5	N.Pt. 7 (Lot)	1	180.40	
H. Geurkink	5	Pt. E 1/2 18	15	1137.93	571.69
Delmar Adams	5	Pt. W 1/2 18 &	14	1290.99	2286.51
<i>Richard Zandbergen</i> Horst Mattiesen	6	Pt. Lot 16	1	101.91	
Evelyn Smal	6	Pt. Lot 16	0.68	125.45	
F. Zandbergen	6	Pt. Lots 17 & 18	4	317.75	
H. Geurkink	6	Pt. Lot 18 +	10	702.36	6782.47
Annie McQuigge	6	Pt. 17 (Lot)	0.9	32.94	
Clara Johnston	6	Pt. 17 (Lot)	0.5	109.75	
R. Zandbergen	6	Pt. 17 (Lot)	0.48	109.75	
J. Zandbergen	6	Pt. 17 (Lot)	0.53	117.60	
J. Geurkink	6	Pt. 18 (Lot)	0.56	121.53	
H. Geurkink	6	Pt. 18 (Lot)	0.55	125.45	171.41
W. D. Fawcett	5	N. Pt. 17	0.33	60.13	
D. McQuigge	6	Pt. C. Commons (Lot)		70.51	
G. Coleman	6	Pt. C. Commons	1.2	137.18	

SCHEDULE OF ASSESSMENT (Cont.)

Name of Owner
 Con. Lot or Part Acres Drained
 Outlet Liability
 Benefit Liability

VILLAGE LOTS

6	C. Coons*	Pt. Centre Commons	0.35	97.98	199.97
6	H. Munroe*	"	0.60	137.21	352.33
6	H. Plante*	"	0.25	82.29	147.60
6	A. Moran*	"	0.25	82.29	149.18
6	G. Corker*	"	0.18	70.51	107.92
6	H. Plante*	"	0.17	70.51	101.57
6	Un. Coop.*	"	0.30	94.06	182.52
6	C. Murphy*	"	0.40	100.94	250.76
6	C. Murphy*	"	0.18	74.46	114.26
6	D. Feder* C. Code	"	0.09	58.71	57.13
6	C. Code*	"	0.46	121.53	293.61
6	G. Murphy*	"	0.48	125.44	307.90
6	Wm. Perry*	"	0.25	86.21	161.89
6	F. Churchill Ault*	*	0.55	141.15	360.26
6	L. Henderson*	"	0.27	90.11	177.75
6	Irene Bailey*	"	0.31	97.99	204.74

TOWNSHIP OF MATILDA

Township Road betw. Con. 5 & 6* 5.3 1279.22

Special Benefit Assessment, Project # 1260 9472.94

UNITED COUNTIES OF STORMONE, DUNDAS & GLENGARRY

County Road # 2, Con. 5, & 6# 6.7

1613.73

* = NON AGRICULTURAL

ALLOWANCES FOR LAND TAKEN

Name of Owner Con. Lot or Part Allowance

Delmar Adams	5	Part 18 and Centre Commons	\$290.22
H. Geurkink	6	Pt. Lot 18 and Centre Commons	957.69

ALLOWANCES FOR DAMAGES

Delmar Adams	5	Pt. 18 and Centre Commons	698.32
H. Geurkink	6	Pt. 18 and Centre Commons	1975.19

SCHEDULE OF FARM CROSSINGS

Name of Owner	Con.	Lot or Part	Diameter	Length	Gauge
Delmar Adams	5	Pt. 18 and Centre Commons	24"	30'	16 (3x)
H. Geurkink	6	Pt. 18 and Centre Commons	48"	30'	12 (1x)
H. Geurkink	6	Pt. 18 and Centre Commons	48"	30'	12 (2x)

GENERAL SPECIFICATIONS

1. These specifications are drawn up to cover the work as outlined in the Engineer's Report on the drain, the said report forming part of these specifications.

Where there is any doubt as to the meaning or intention of the report and specifications as a whole, it shall be the Contractor's duty to obtain a ruling from the Engineer before proceeding with the work.

2. The work to be done shall consist of making the necessary excavation to the grade and dimensions as shown on the accompanying profile and more particularly described in these specifications, also, the cutting of any brush that may be necessary, grubbing of roots and the removal and disposal of all excavated material to points hereinafter mentioned.

Particular care must be taken that all straightening recommended is to be carried out. Portions of the drain to be straightened are indicated on the profile by those portions coloured yellow which extend up to the hub line.

3. SUPPLY OF LABOUR, MATERIAL, ETC.

The Contractor shall furnish all labour, tools, implements, machinery, material, etc., which will be necessary for the full and proper completion of the work, in accordance with these specifications, plan and profile. All work must be done to the satisfaction of the Engineer.

4. ROADS TO BE KEPT OPEN

All public and private roads shall be kept open and in a passable condition during the continuance of the work.

5. RELIEF DITCHES

In case the Contractor may make relief ditches, he must do so and refill the same at his own expense.

DAMAGES

In case of damage being done to any farm or other property along the line of work by blasting or other operations, the contractor shall be held liable for such damage.

The contractor shall also rebuild and leave in as good condition as possible all fences removed in order to execute the work. When hay or other produce is growing on lands adjacent to the proposed work, the contractor must give the owner ten (10) days notice in writing to remove the same before he begins work on that portion, otherwise he shall be held liable for any damage caused.

CLEARING AND GRUBBING

Any brush growing on the banks or in the ditch must be grubbed out clean. Small brush removed is to be piled in a neat and workmanlike manner so that it may be burned by the farmer. Large trees are not to be cut unless absolutely necessary for the execution of the work. If large trees are cut, the stumps are to be removed from the premises to a suitable dumping place away from the cultivated land, and away from the spreading area. If a suitable dumping place is not available on the property on which the drain is located, then the stumps will be removed to the Township dump by the contractor as part of his contract.

Small branches are to be cut and piled so that they may be burned by the farmers, and the trunks of large trees and branches cut into log lengths and piled clear of the drain so that they may be salvaged by the farmer. I wish to impress upon contractor that he is to avoid cutting large trees if at all possible. Also, the necessity of carrying out grubbing in a clean and workmanlike manner. If the contractor wishes to bulldoze out small shrubs into piles, he shall be responsible for the burning of this material. The spreading of spoil directly on small brush without previous grubbing will only be allowed in swamp and muck land at the locations mentioned later in these specifications.

DISPOSAL OF MATERIAL

The excavated material shall be disposed of so as to do as little damage to lands and crops as possible. In cultivated land, it shall be taken back at least 8 feet from the edges of the finished drain, leaving a berm of 8 feet in width on which no material is to be spread. Channels shall be cut every 300 feet to prevent stagnant surface water from building up behind the spreading area. If the earth is spread along unopened road allowances, it shall be so spread that no holes remain along the roadway and so crowned that no water will remain along the roadway, or lie on the roadway.

The excavated material shall be spread and levelled by means of a bulldozer, or similar equipment so that the finished work presents a neat appearance and leaves the land so that it can be easily worked by the farmer and spread in such a manner that the average elevation at any particular location does not exceed the elevation of the adjoining land by more than 6 inches in cultivated land and 12 inches in the case where spreading is done in wooded areas.

All hardpan, stumps and stones shall be disposed of by the contractor. Hardpan or stones may be buried by the contractor if covered by at least 36 inches of good soil. Stumps will have to be removed from all work land. No hardpan is to be spread on work land or land that will be in a workable state after removal of brush or willow shash.

Where straightening occurs, as shown on the plan and profile, the contractor shall fill in the abandoned ditch throughout its entire length from shoulder to shoulder with the excavated material taken from the drain. They may, or may not, entail transportation of the excavated material by trucks or other equipment. The cost of this work is to be included in the unit price for excavated earth quoted by the contractor in his tender price.

DESCRIPTION OF DITCH

The bottom of the ditch shall be brought to an even grade between the stations so that no water may lie stagnant therein.

Rock cuts, should they occur, shall have vertical sides and width equal to the specified bottom width of the drain at that point.

It is essential that the side slopes shall not be greater than that specified. The contractor shall not be allowed to increase the bottom width without maintaining the specified side slopes.

BOTTOMWIDTH:

From Station 4+50 to Station 24+08 3 feet
From Station 24+74 to Outlet 4 feet

SIDESLOPES:

All Sidelopes 1 1/4 horizontal to 1 vertical.

New cuts between Station 21+50 and Station 23+22
New cut along the South and East side of Lot 8A
owned by Mr. C. Murphy. Ground to be deposited on
Lot and spread, Old ditch to be filled.
New cut between Station 27+05 and Station 31+22.
Old course to East to be filled.

LOCATION OF THE DRAIN ALONG COUNTY ROAD # 2.

West bank of the new Drain along County Road # 2 will be
no closer than 33 feet to the centerline of the County Road,
which brings it to the East side of a row of power poles.
The West edge of the new Drain shall be 24 inches from the East
face of the power poles. Fences to be taken up and replaced
by the contractor as part of his contract. Any new fencing
material needed shall be supplied by the owner.

The entire Drain shall be constructed in a straight line
parallel to general centerline of the County Road.

Fencing shall be replaced in a straight line no closer
than 24 inches away from the East edge of the new Drain. All
satisfaction of the Engineer. This includes braces, corner-
post and gateways as found prior to construction of the Drain.

The spoil from the new Drain shall be used to build up
and re-inforce the East shoulder of the County Road to a
level not exceeding in height the East edge of the blacktop.
Finished shoulder shall have a slope towards the new ditch
of one foot vertical to ten feet horizontal. All work along
the County Road to be done to the satisfaction of the County
Engineer and his representatives. The County Road Department
shall be notified by the contractor 48 hours in advance of
any work along County Road # 2. Excess of spoil shall be
spread over the farmland along the East side of the Drain.

Wherever there is a dike along the East side of the Drain, the excess spoil shall be dumped across the dike to the land immediately beyond the dike and spread in low spots next to and along the dike.

A low pond at the extreme Northwest corner of the property, which is opposite the North end of the dike, shall be filled with at least 200 cubic yards of spoil from the new ditch.

A low area 500 feet to the East of Station 92+85 shall be filled with at least 200 cubic yards of earth to block a local ditch towards the South, to prevent the overflow from the South Branch of the Nation River to use this local ditch as an alternate course. The finished level of the ground shall be no lower than the average level of the dike along the West side of Lot 18. Upon request pickets will be placed by the Engineer, which will indicate the correct height at these various points.

Between Station 32+12 and Station 33+68 the Drain shall be widened to the North side only. Fence to be taken up and replaced by contractor in such a way that the new fence shows no logs which means that approximately 500 feet of fence will have to be taken up and re-erected as part of the contract.

Wherever the Drain runs alongside village lots, widening shall be done away from those lots so as to preserve existing fences and corner-surveybars.

BELL CANADA BURIED TOLL CABLE

Immediately upon being awarded the contract on the Drain, contractor shall notify Bell Canada so that Bell Canada can take appropriate steps to protect this cable which crosses the Drain at Station 61+07 on the Plan.

SCHEDULE OF FARM CROSSINGS

Name of Owner	Con.	Lot or Part	Diameter	Length	Gauge
Delmar Adams	5	Pt. 18 and Centre Commons	24"	30'	16 (3x)
H. Geurkink	6	Pt. 18 and Centre Commons	48"	30'	12 (1x)
H. Geurkink	6	Pt. 18 and Centre Commons	48"	30'	12 (2x)

FARM CROSSINGS

Included in this contract is the supply and installation by the contractor of a number of farm crossings as shown on the accompanying schedule.

It is the contractor's duty to contact each owner prior to the installation of each crossing to determine its most desirable location. The old pipes remain the property of the land-owners.

Only new, galvanized, corrugated steel culverts are to be used having the correct inside diameter, length and gauge as indicated in the schedule. The quality of the pipes is subject to the approval of the Engineer.

Each pipe will be laid on undisturbed soil and at the correct bottom grade. Construction of the crossings includes the backfill which will be shaped and compacted by the contractor in a good and workmanlike manner to the satisfaction of the Engineer. The minimum cover over each pipe will be 12 inches regardless of the level of the surrounding field, and the minimum width of each roadway across the pipe will be 16 feet. Ground used for backfill over culverts shall not contain old wood or other debris, nor stumps. Backfill with soil containing a high percentage of muck or pure sterile sand must not be used.

RIP-RAP

Both ends of each culvert will be rip-rapped with stone, hand placed, starting from the bottom of the new drain to a level of 1 foot below the average field elevation. Stones will have a minimum thickness of 8 inches and will be laid flat on top of each other with an inward slope of 6 inches per foot of height. All stones for rip-rap shall be supplied by the contractor. This work is to be done in a neat and workmanlike manner to the satisfaction of the Engineer.

The contractor is responsible for one year from the date of the final acceptance of the work for washing out of a culvert, the falling down of rip-rap or the washing off of cover, if due to faulty installation. This will be determined by the Engineer.

The contractor shall contact each owner along the drain to have the location of underground tile outlets marked out in the field.

All access culverts to farm buildings will be finished off with at least 8 cubic yards of 3/4 inch crushed stone on gravel over at least 18 inches of pitrun gravel properly compacted to avoid settling of material. If untimely settling takes place causing a dip in the laneway, contractor will be held responsible to repair the same up to a time limit of one year from the time of final approval by the Engineer. This also applies to rip-rap on all culverts.

GRADES

Grades will be given to the contractor upon receiving written notice five (5) days previous that the same are required.

COMPLETION

At the date fixed for the completion of the work, there shall be a continuous ditch or watercourse of the dimensions set forth in the drawings, specifications, etc.; and any material which may have accumulated or fallen into the ditch shall be removed by the contractor except that it can be clearly shown that such accumulation was not caused by any action or want of action on the part of the contractor or his employees.

CLASSIFICATION

Excavation shall be paid for under the following headings: Earth, Hardpan, and Rock.

"Earth" shall mean sand, clay, gravel, small stones or muck.

"Hardpan" shall mean such material other than rock that cannot be removed by the ordinary means but requires the use of picks, bars, or explosives in its removal.

"Rock", if encountered, shall mean strata rock, or boulders measuring 14 cubic feet or more.

A price per cubic yard shall be named on the tender for each material which shall include the removal of any brush from the ditch or banks.

RECLASSIFICATION

No claim for reclassification of material will be allowed without positive evidence as to the exact location where the reclassification is necessary, and in the case of boulders, the exact size (height, width and circumference measured in two directions) of each boulder encountered.

FARM BRIDGES

It is the contractor's duty to clean out under the farm crossings and bridges on the drain. Where such crossings have not the width of 3/5 of the summation of the top and bottom widths of the drain, the contractor is to notify the owner to remove the same. If after four (4) clear days notice in writing the owner does not remove his farm bridge, the contractor is to remove the same and is to exercise reasonable caution so as to not damage the material unduly and is to pile

all the timber, etc., 15 feet clear of the edge of the ditch. Where the farm bridges have the widths as specified, the contractor may remove the flooring for the purpose of cleaning but must replace the same in as good condition as before removal.

ROAD CULVERTS

The contractor is to clean out under any existing open bottom road culverts which are of sufficient size and is also to clean out any such pipe culvert which has been accepted by the Engineer as being of a satisfactory size and at a proper depth.

Any work other than the above which may be required at the site of the road culvert shall be charged against the road costs and shall be the responsibility of the Road Superintendent concerned. In order to make this equipment available for any excavation required by the lowering or replacing of a pipe culvert. However, the contractor shall give the Road Superintendent concerned ten (10) days notice in writing informing him when he will reach the site of any given culvert requiring work. Should the Road Superintendent prefer to carry out the work using his own equipment and personnel, the contractor shall only be required to excavate to the grade up to and away from any such culvert.

RIGHT TO INCREASE OR DECREASE THE WORK

The Municipality reserves the right when it is deemed advisable by the Engineer to increase or decrease the amount of excavation or to deviate from the line or grade of the proposed work as shown by the drawings, but no variation shall be made from the price per cubic yard named in the contract, in consequence of any such change.

SUB-LETTING

No portion of the work is to be sub-let without the consent of the Municipal Council and the Engineer.

DEPOSIT TO ACCOMPANY TENDER

A cash deposit or certified cheque on a chartered bank for the sum amounting to ten percent of the tendered price must accompany each tender. Such deposit will be returned to the unsuccessful bidders at once.

The cash deposit of the successful bidder may be retained until 37 days after the work has been accepted as finished.

The whole work shall be completed on or before the day of 19, including the spreading, and when the Contractor considers that the work is completed he must notify the Engineer in writing that he requires a final inspection thereof.

The cost of inspecting the work done by the Contractor shall be paid by the municipality. However, should it be found that the work, upon inspection by the Engineer, has not been done in accordance with these Specifications, the Contractor shall then be responsible for any subsequent costs brought about by all extra work necessary for the ultimate final approval of the work, e.g., replacing hubs, re-inspecting the work, etc., and the cost of this extra work shall be deducted from the final progress payment issued to the municipality.

The Contractor shall forfeit the amount of \$10.00 per day from his contract for every day's delay in completing the work after the date of completion unless he has been granted an extension of time by the Council of the Municipality.

19. PAYMENTS

Cash payments will be made monthly equal to eighty-five percent of the value of the work done on the certificate of the Engineer should the amount of work done within the month amount to Three Hundred Dollars (\$300.00). The remaining fifteen percent will be retained until thirty-seven (37) days after the whole work has been accepted as finished.

20. RIGHT TO REJECT TENDERS

The Municipal Council reserves the right to reject any or all tenders.

21. WORKMEN'S COMPENSATION

The Contractor shall comply with the Regulations of the Workmen's Compensation Board of Ontario.

22. MEANING OF TERMS

In the foregoing Specifications, the words: "Municipal Council" shall mean the Municipal Council of the Township of Matilda.

"Reeve" shall mean the Reeve of the Township of Matilda.

"Engineer" shall mean the Engineer in charge of the work or his authorized representative.

18. DATE FOR COMPLETION

BRINSTON DRAIN.
of the
PLAN
TOWNSHIP OF MATILDA.

CONSTRUCTION 1977.

SCALE: 1" = 600'

STIDWILL & ASSOCIATES LTD.
CONSULTING CIVIL ENGINEERS
CORNWALL ONTARIO

DATE: APRIL 4 - 1977
PER: B.S. CE 6.0LS

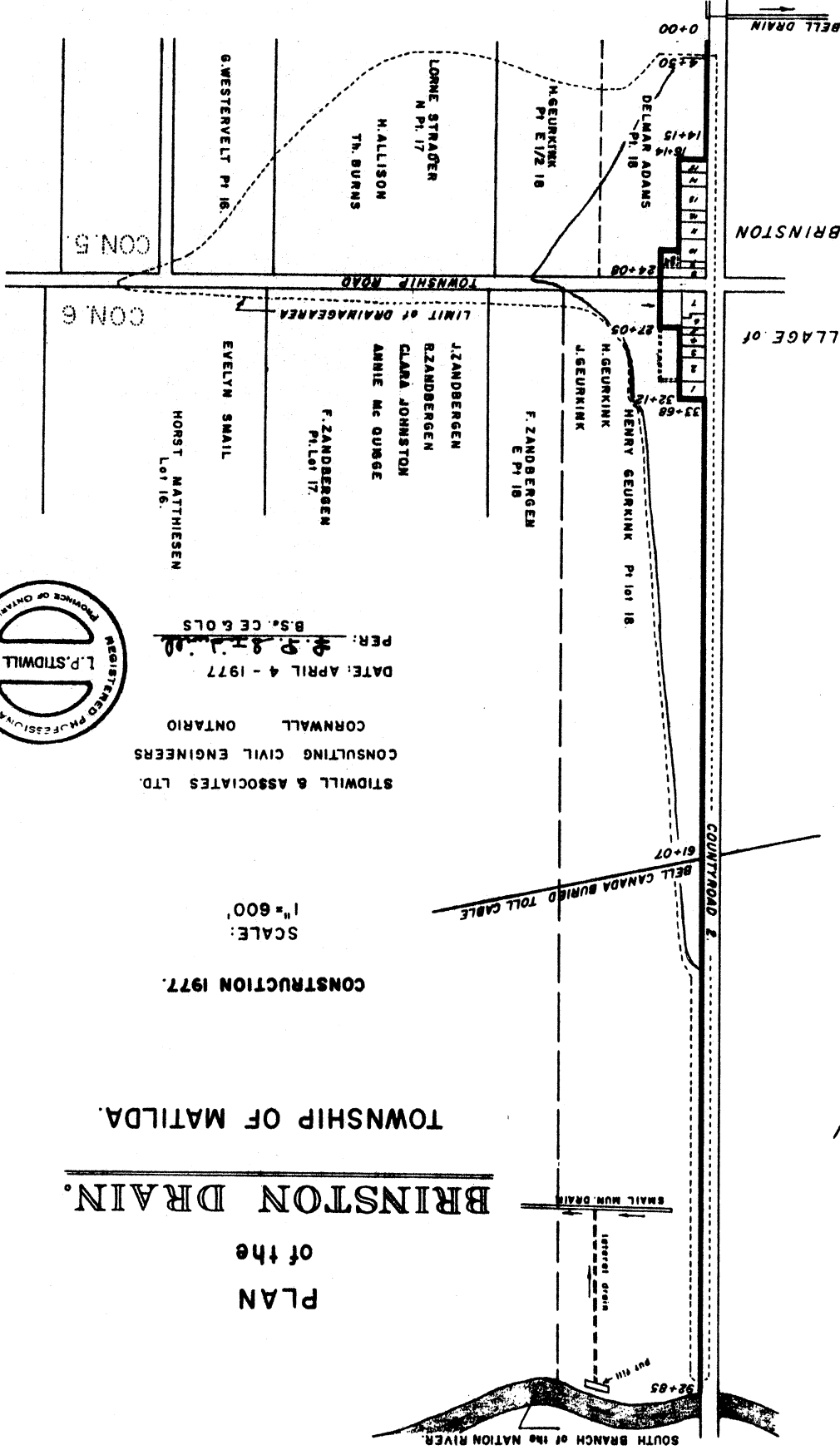
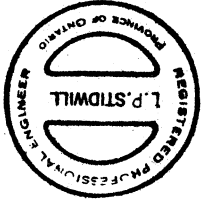

1. C. COONS
2. M. MUNROE
3. H. PLANTE
4. A. MORAN
5. G. CORNER
6. H. PLANTE
7. UN. COOP.
8. C. MURPHY
9. C. MURPHY
10. C. CODE
11. G. MURPHY
12. W. PERRY
13. F. WINSTON AULT
14. L. HENDERSON
15. I. BAILEY

BRINSTON DRAIN

MATILDA TOWNSHIP

CONSTRUCTION - 1977

SCALE 1" = 400 HOR.
1" = 4' VERT.

SPRUELL & ASSOCIATES LTD.
CONSULTING CIVIL ENGINEERS
CORNWALL ONTARIO

DATE - APRIL 4, 1977
BY - SP
CHK. CE

ENGINEER



PROFILE
OF THE

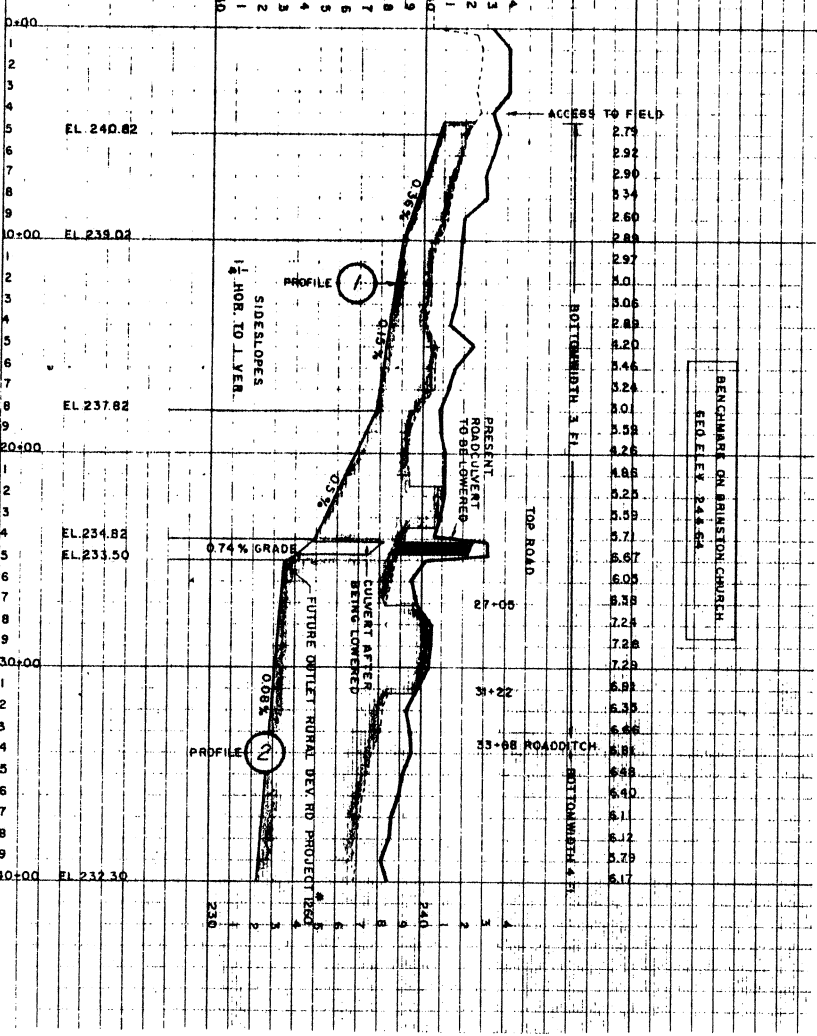

BENCHMARK ON BRINSTON CHURCH
SEO. ELEV. 244.54

© QUANTZ

