

TOWNSHIP OF MOUNTAIN G.D. BALDWIN DRAINAGE SCHEME

COMPRISING OF
G.D. BALDWIN DRAIN
G.D. BALDWIN EXTENSION
GRAHAM BRANCH
SAM KEYS BRANCH
LOTS 12 to 15 CON I

Reeve - E. Simms
Clerk - Joan Maxwell

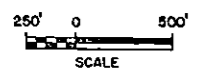
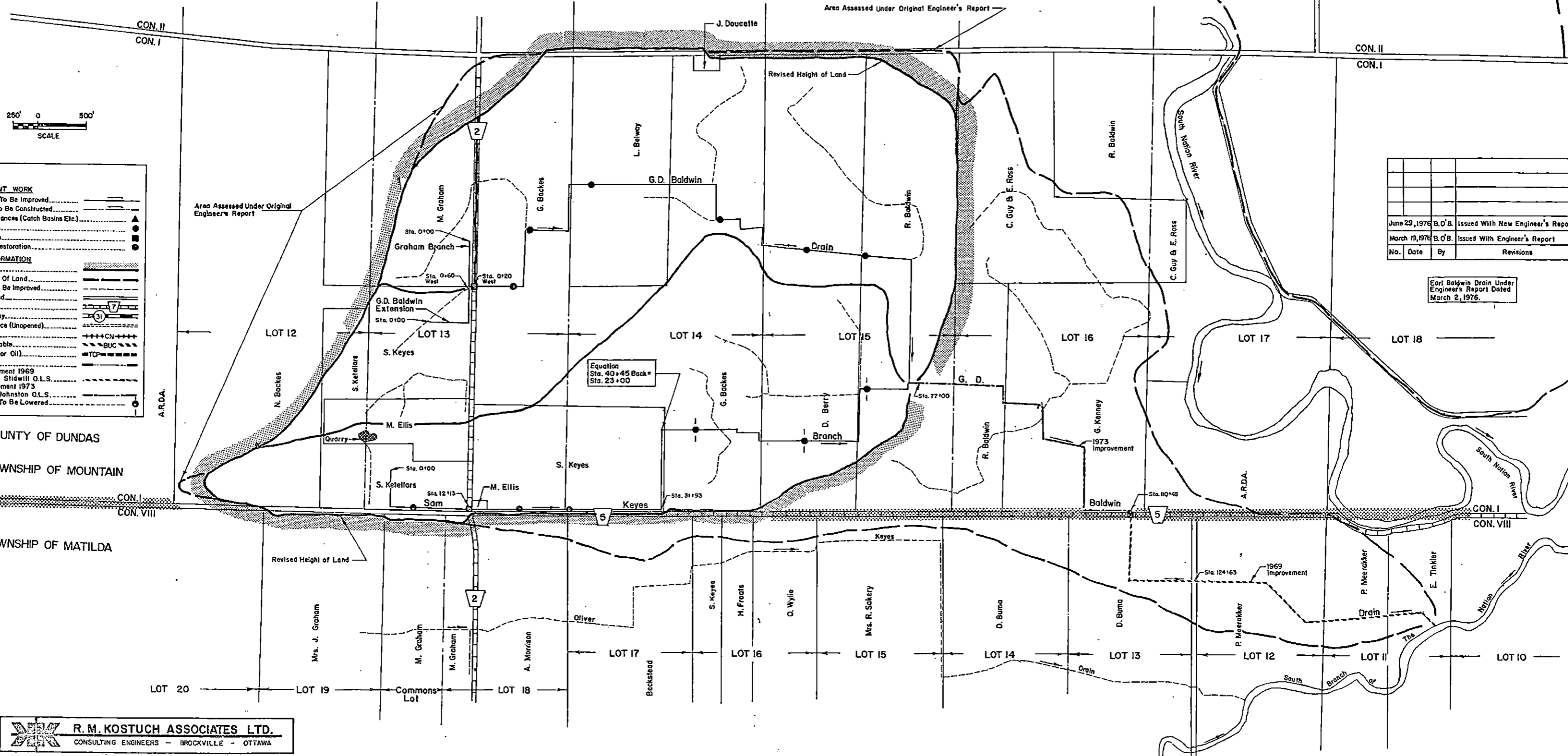

LEGEND

IMPROVEMENT WORK

- Open Drains To Be Improved
- Tile Drains To Be Constructed
- Tile Appurtenances (Catch Basins Etc.)
- Farm Bridges
- Road Bridges
- Farm Pond Restoration

OTHER INFORMATION

- Outlet Area
- Other Heights Of Land
- Drains Not To Be Improved
- Township Road
- County Road
- King's Highway
- Road Allowance (Unopened)
- Railway
- Buried Bell Cable
- Pipeline (Gas or Oil)
- Match Line
- Drain Improvement 1969 Report by L.P. Stidwill Q.L.S.
- Drain Improvement 1973 Report by W. Johnston Q.L.S.
- Farm Bridges To Be Lowered

No.	Date	By	Revisions
June 29, 1976	B.O.B.		Issued With New Engineer's Report
March 19, 1976	B.O.B.		Issued With Engineer's Report

Earl Baldwin Drain Under Engineer's Report Dated March 2, 1976.