

THE CORPORATION OF THE MUNICIPALITY OF SOUTH DUNDAS

BY-LAW NO. 2026-34

A BY-LAW of the Corporation of the Municipality of South Dundas to assess the maintenance costs of the Westervelt Municipal Drain.

WHEREAS section 74 of the *Drainage Act*, R.S.O. 1990, c. D.17 (the "Act") authorizes a municipality to maintain and repair a drain constructed under the Act and to assess the costs thereof upon the lands and roads in the drainage area in the same proportion as the original construction assessment;

AND WHEREAS the maintenance works requested on the Westervelt Drain are now complete and the accumulated costs are \$1,566.08;

AND WHEREAS the applicable 1/3 grant has been deducted from the gross assessment for agricultural lands;

AND WHEREAS it is necessary to levy the respective costs in the same proportion as authorized in construction By-Law No. 98-48 of the former Matilda Township.

NOW THEREFORE the Council of the Corporation of the Municipality of South Dundas enacts as follows:

1. The assessments as detailed in Schedule "A" are hereby levied on the applicable properties and are due and payable on or before June 30, 2026.
2. Late payments will accrue interest at the prevailing tax rate of 1.25% per month.

READ and passed in open Council, signed and sealed this 29th day of April, 2026.







MAYOR



CLERK

SCHEDULE A
 To By-Law No. 2026-34
 Westervelt Drain (98-48)

Roll # (0506-)	Assessed Amount
006-007-05404	\$ 39.43
006-007-05404	228.53
006-007-05600	161.09
006-007-05800	1.38
006-007-06000	189.62
006-007-05404	403.66
006-007-06200	5.07
006-006-46200	1.10
Municipality of South Dundas	11.50
United Counties of S.D. & G.	13.07
	<u>\$ 1,054.44</u>

LEGEND:

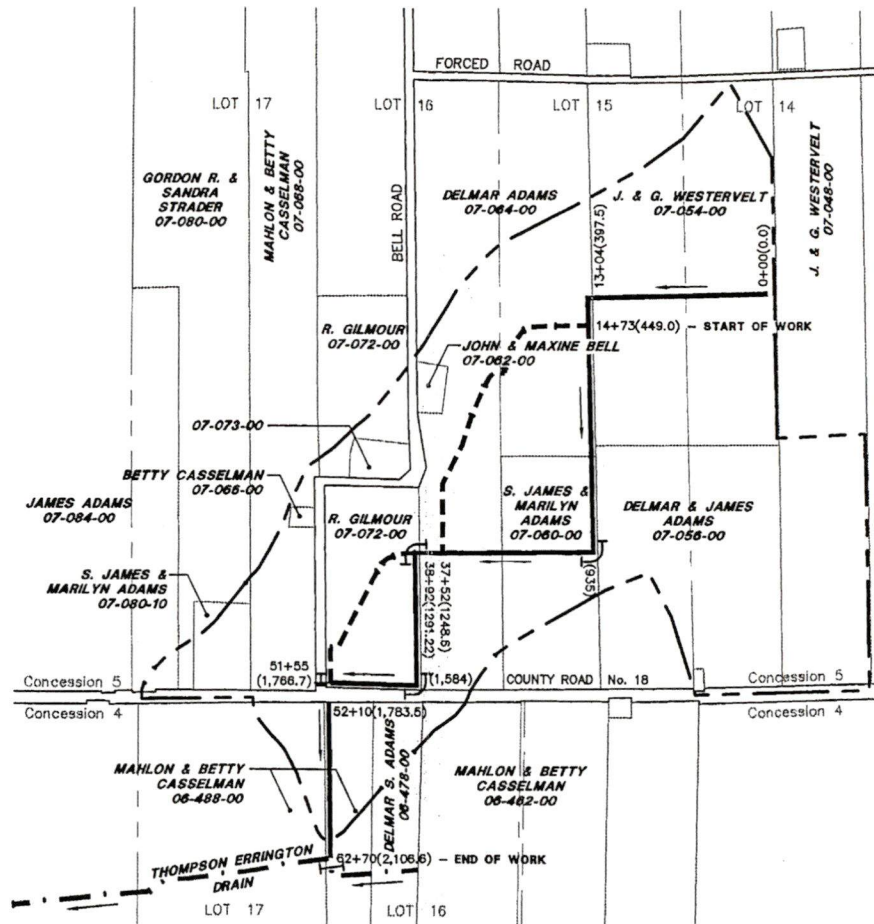
-  MAIN DRAIN (FLOW DIRECTION)
-  DITCH TO BE ABANDONED
-  HEIGHT OF LAND
-  EROSION PROTECTION
-  THOMPSON ERRINGTON DRAIN
- 14+73(449.0) STATION (DISTANCE m)



 totten sims hubicki associates
ENGINEERS ARCHITECTS AND PLANNERS

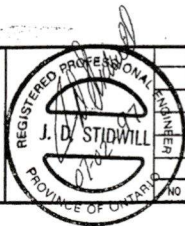

NO	DATE	BY	REVISIONS

DESIGNED: J.D.S.
 DRAWN: T.A.M.
 CHECKED: J.D.S.
 APPROVED: J.D.S.
 SCALE: 1:10,000

**WESTERVELT MUNICIPAL DRAIN
 TOWNSHIP OF MATILDA**

DATE: FEB. 7/97
 PROJECT: 18-12489

PLAN

1

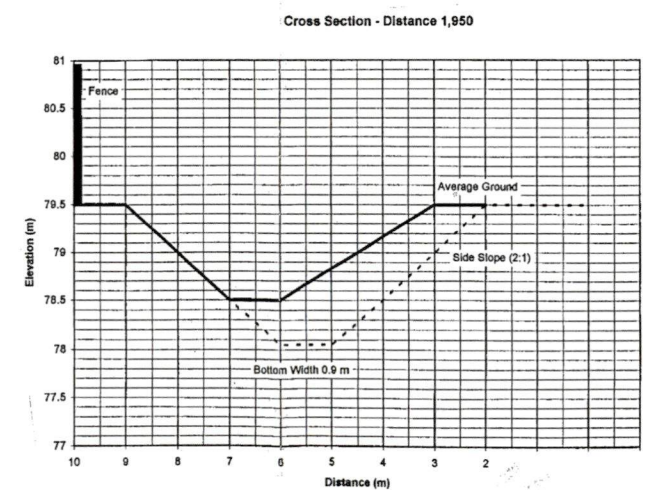
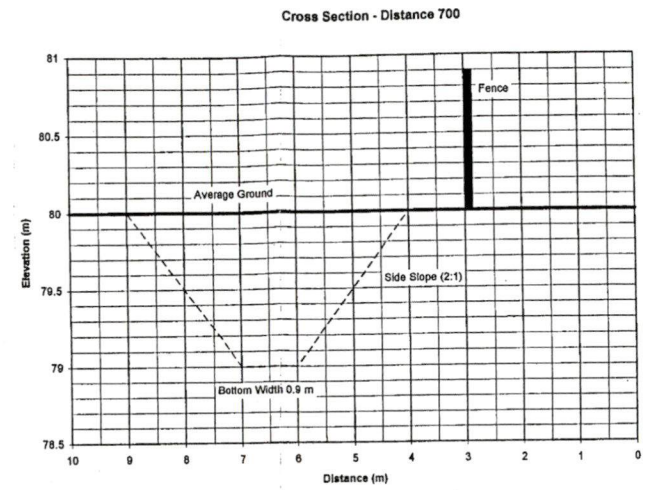
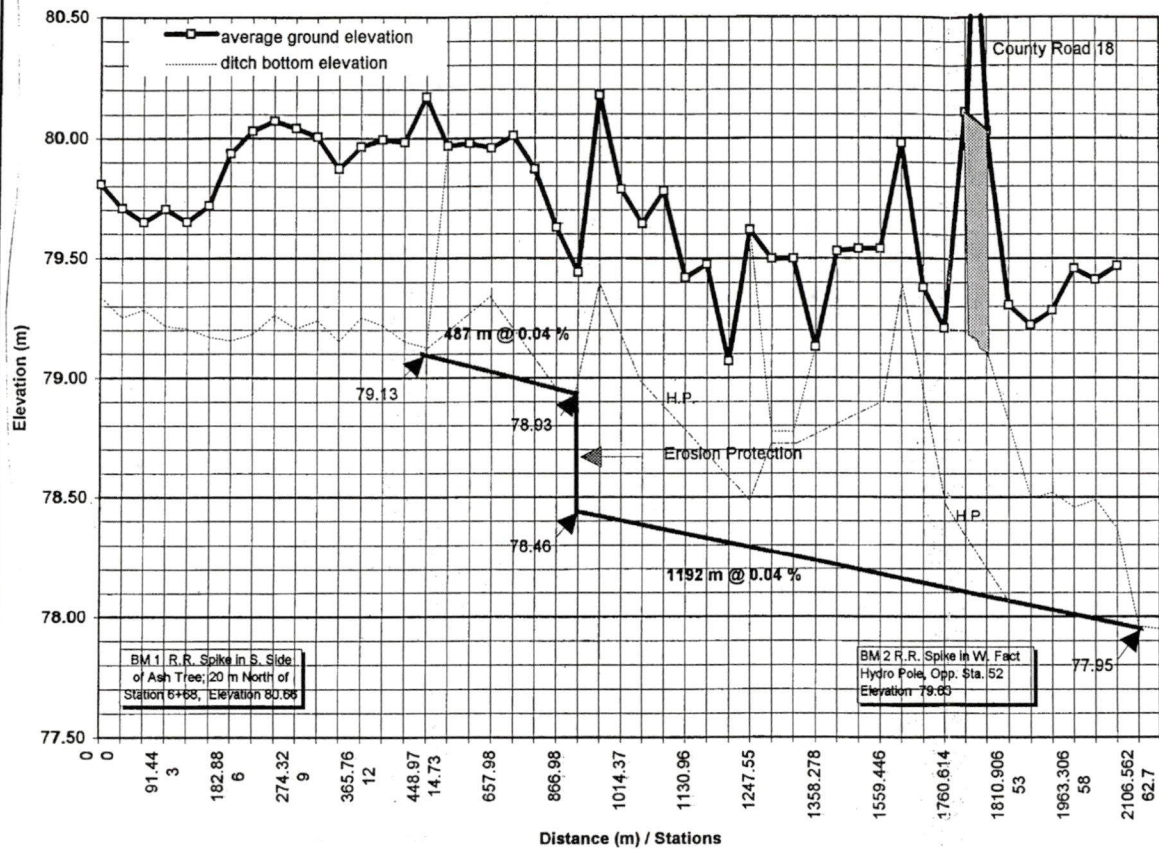

totten sims hubicki associates
ENGINEERS ARCHITECTS AND PLANNERS



NO	DATE	BY	REVISIONS

DESIGNED:	J.D.S.
DRAWN:	T.A.M.
CHECKED:	J.D.S.
APPROVED:	J.D.S.
SCALE:	N.T.S.

WESTERVELT MUNICIPAL DRAIN
TOWNSHIP OF MATILDA

DATE: FEB. 7/97
PROJECT: 18-12489

PROFILE

2